

363/12

68/9

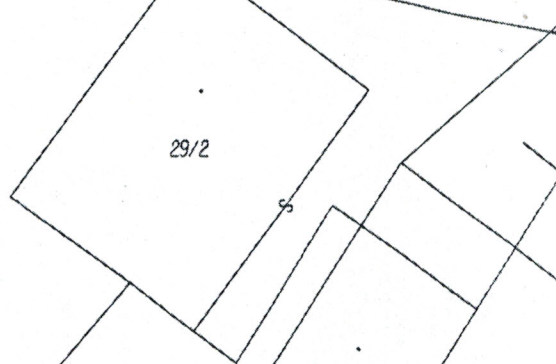

29/2



29/4



363/11

144-2870



368/3

144-2845

368/29



440

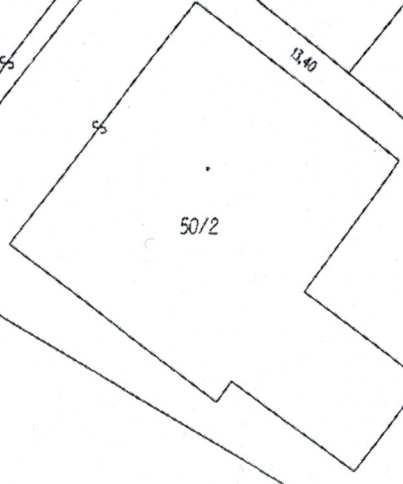

50/2

453

144-2903

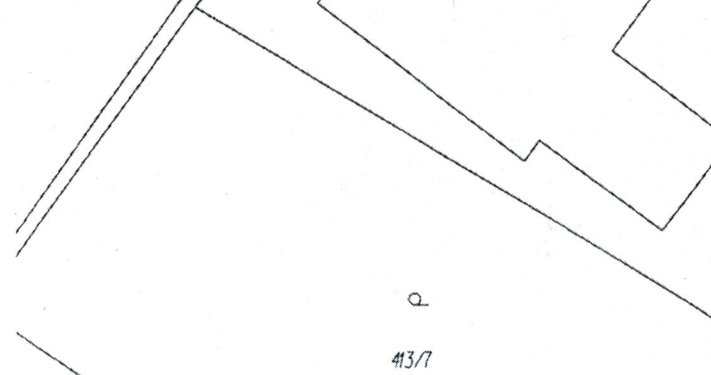

413/7

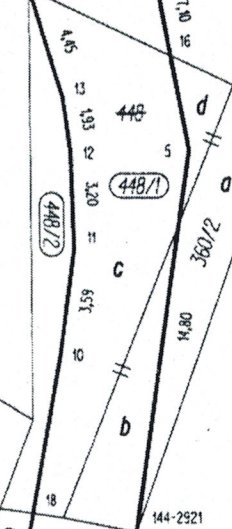

360/2

a

b

c

d

44B

44B/1

44B/2

1.70

15.70

4.85

3.15

3.10

3.20

11.50

6.57

14.80

14.80

14.80

14.80

14.80

14.80

14.80

13.80

13.80

13.80

13.80

13.80

13.80

13.80

13.80

13.80

13.80

13.80

13.80

13.80

13.80

13.80

13.80

144-2921

454

3.70

2.57

144-2910

31/1

⊕

359/8

29/3

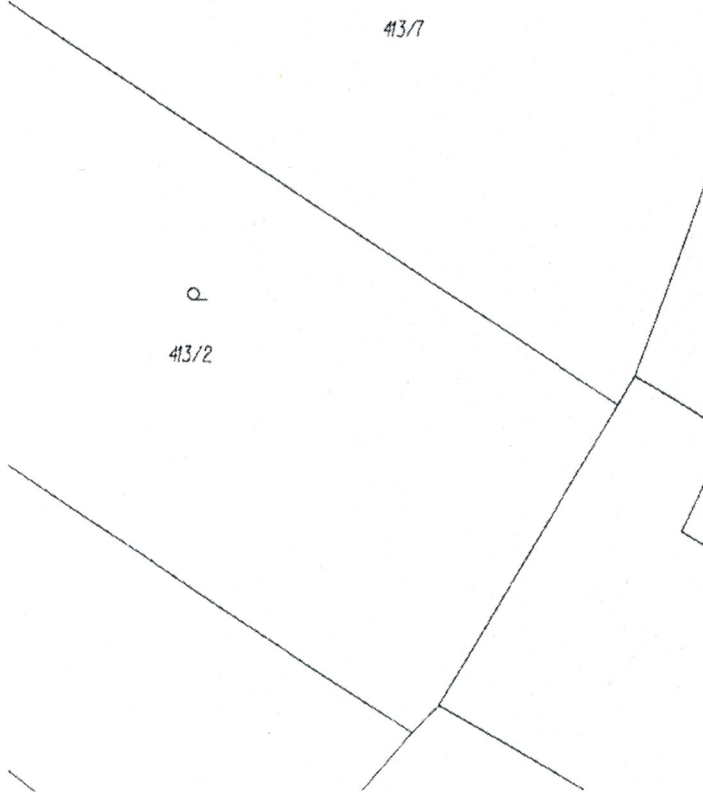

413/2